

**DEMOLITION NOTES:**

1. CERTAIN ITEMS ARE INDICATED "TO BE REMOVED" OR "REMOVE". THIS PERTAINS TO WORK OR ITEMS WHICH THE CONTRACTOR SHALL REMOVE AND EITHER STORE OR DISPOSE OF. THE OWNER SHALL HAVE THE RIGHT TO SALVAGE ALL ITEMS BEING REMOVED.
2. CERTAIN ITEMS ARE DESIGNATED "TO BE RELOCATED" OR "RELOCATE". THIS PERTAINS TO WORK OR ITEMS WHICH THE CONTRACTOR SHALL REMOVE FROM ITS PRESENT LOCATION AND RELOCATE AS INDICATED ON THESE DRAWINGS, AND IN SUCH MANNER AS TO RETAIN THEIR PRESENT CONDITION AND EFFECTIVENESS.
3. THE CONTRACTOR SHALL MAKE SECURE AT THE END OF EACH WORKING DAY ALL OPENINGS INVOLVED WITH HIS WORK, IN A MANNER THAT WILL PROVIDE ADEQUATE SECURITY FROM INTRUSION OF UNAUTHORIZED PERSONS.
4. AT NO TIME SHALL THE EXISTING BUILDING BE LEFT UNPROTECTED TO THE ELEMENTS AT THE END OF A WORKING DAY OR DURING WEATHER WHICH MAY CAUSE DAMAGE TO THE OWNERS EXISTING PROPERTY. TEMPORARY PROVISIONS SHALL BE PROVIDED TO SEAL ALL SUCH OPENINGS AT THE END OF EACH DAY, WHEN WEATHER CONDITIONS ARE SUCH THAT DAMAGE TO EXISTING PROPERTY COULD RESULT, OR WHEN DIRECTED BY THE ARCHITECT. THE CONTRACTOR SHALL MAKE SUCH PROVISIONS WATERTIGHT AND MAINTAIN THEM FOR AS LONG AS IS NECESSARY AND REQUIRED. THE CONTRACTOR SHALL COORDINATE THE REMOVAL OF THOSE ITEMS WHICH WILL LEAVE THE INTERIOR OF THE EXISTING BUILDING EXPOSED, SUCH THAT THE RESULTING EXPOSURE SHALL BE KEPT TO A MINIMUM.
5. ALL EXISTING ITEMS AND PROPERTY, WHICH ARE TO REMAIN, SHALL BE PROTECTED FROM ANY DAMAGE RESULTING FROM THIS CONTRACTOR'S WORK AND/OR HIS RESPONSIBILITIES AS OUTLINED HEREIN. THEN CONTRACTOR SHALL BE RESPONSIBLE FOR REPAIRING OR REPLACING ANY EXISTING ITEMS OR PROPERTY, WHICH ARE DAMAGED AS A RESULT OF HIS WORK.
6. THE CONTRACTOR WILL BE RESPONSIBLE FOR PATCHING WHERE DEMOLITION WORK HAS BEEN DONE. HE SHALL FURNISH AND SUPPLY MATERIAL REQUIRED TO PERFORM PATCHING WORK. IN ALL INSTANCES HE SHALL MAKE THOSE AREAS REQUIRING PATCHING TO MATCH EXISTING ADJACENT AREAS.
7. THIS CONTRACTOR SHALL TAKE ALL NECESSARY PRECAUTIONS FOR THE SAFETY OF EMPLOYEES AND WORK, AND SHALL COMPLY WITH ALL APPLICABLE PROVISIONS OF FEDERAL, STATE, AND MUNICIPAL SAFETY LAWS AND BUILDING CODES TO PREVENT ACCIDENTS OR INJURY TO PERSONS ON, ABOUT, OR ADJACENT TO THE PREMISES WHEN WORK IS BEING PERFORMED. THE CONTRACTOR SHALL PROVIDE PROTECTION ABOUT HIS RESPECTIVE WORK AND SHALL ERECT NECESSARY FENCES, BARRICADES, AND WARNING LIGHTS IN ACCORDANCE WITH THE PARTICULAR CONDITIONS. ALL NECESSARY SAFEGUARDS SHALL BE MAINTAINED AS NECESSARY THROUGHOUT THE ENTIRE PROJECT AND APPROPRIATE DANGER SIGNS SHALL BE POSTED AS WARNINGS AGAINST ALL HAZARDS CREATED BY THE CONSTRUCTION WORK.
8. ALL DEBRIS RESULTING FROM DEMOLITION, EXCEPT THOSE ITEMS TO BE SALVAGED, SHALL BE REMOVED FROM BUILDING PROMPTLY. RESPONSIBILITY FOR APPROVED DUMPING SITES OR DISPOSAL METHODS SHALL REST WITH THIS CONTRACTOR.
9. CONTRACTOR SHALL PROVIDE SHORING OR SUPPORT FOR ALL AFFECTED STRUCTURES IN SUCH A MANNER AS TO INSURE THEIR INTEGRITY AND PROTECT THEM FROM SETTLEMENT, DAMAGE, OR COLLAPSE.
10. THIS SPECIFICATION DOES NOT CONTEMPLATE THE HANDLING OF, OR DESIGN CONSIDERATION OF/OR INCLUDING THE EXISTENCE OF ANY HAZARDOUS MATERIALS OR WASTE OF ANY MANNER ON SITE. THE OWNER BY INCORPORATION OF THIS SPECIFICATION IN THE CONTRACT DOCUMENTS, AGREE TO HOLD HARMLESS, DEFEND, OR INDEMNIFY THE ARCHITECT, HIS CONSULTING ENGINEERS, PLANNERS, AND CONTRACTORS OF ALL CLAIMS, LAWSUITS, EXPENSES, OR DAMAGES ARISING FROM OR RELATED TO THE HANDLING, USE-TREATMENT, PURCHASE, DEMOLITION, SALE, STORAGE, OR DISPOSAL OF ASBESTOS PRODUCTS OR ANY HAZARDOUS WASTE MATERIALS, PRE-EXISTING ON SITE.

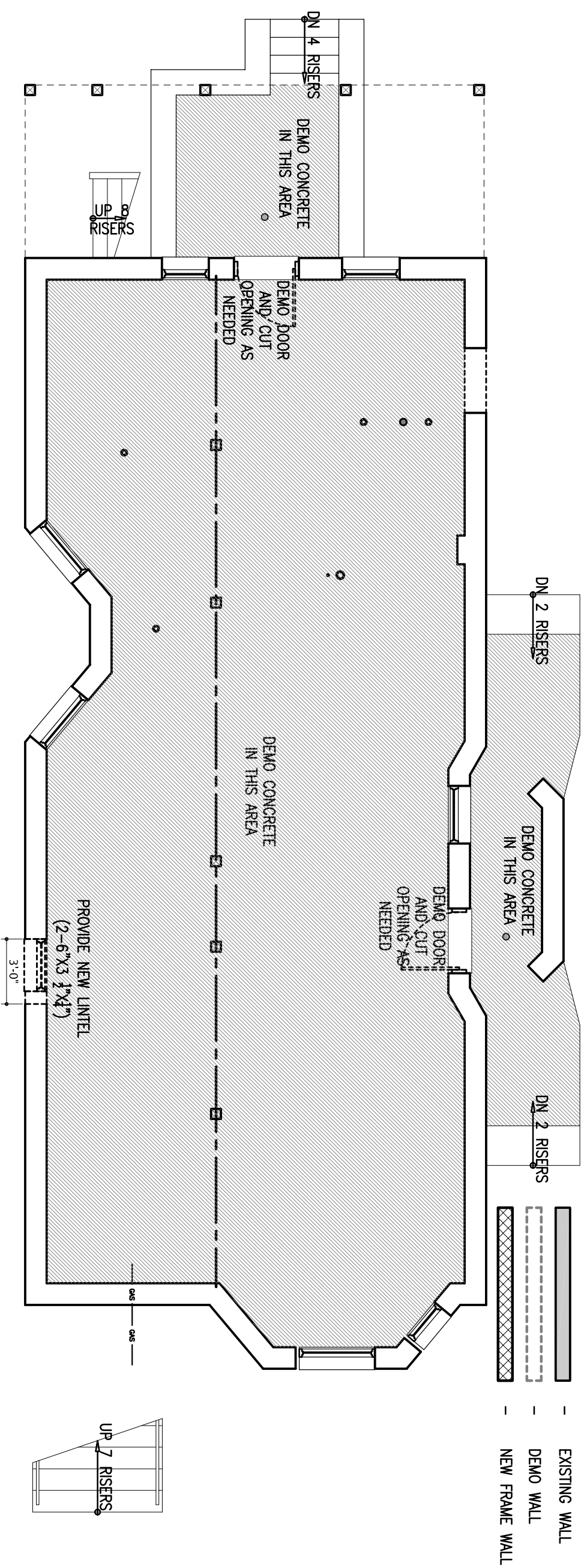

**BASEMENT DEMO PLAN**  
SCALE: 1/4" = 1'-0"



**KB PARTNERSHIP**

419-C Harrison Street  
Oak Park, IL 60304  
Tel: (708) 948-7332  
Fax: (708) 575-3004  
@: us@kbpartnership.com

**PROJECT NAME:**  
PROPOSED GARDEN UNIT

**PROJECT ADDRESS:**  
1613 S. Central Park Av.  
Chicago, IL 60623

**SHEET TITLE:**  
BASEMENT  
DEMOLITION PLAN

**REVISIONS:**  
.....  
.....  
.....

**ISSUED FOR PERMIT:**  
5-07-2009

This drawing is the sole property of KBP, Inc., and is protected under US Copyright Law and the Architectural Works Protection Act of 1990. The copy of this drawing and/or distribution to unauthorized personnel or construction of the structure depicted herein without express written consent of KBP, Inc., would constitute infringement of KBP, Inc. The recipient of this drawing acknowledges and agrees that the ownership of the drawing and all other right, title, and interest therein, including without limitation, all rights under US Copyright and other intellectual property law, are retained by KBP, Inc.

COPYRIGHT © 2009  
ALL RIGHTS RESERVED

SHEET NUMBER:  
**A.3**